

No. of Pins	Dimension(mm)	
	L1	L2
002	5.08	7.62
003	10.16	12.70
004	15.24	17.78
005	20.32	22.86
006	25.40	27.94
007	30.48	33.02
008	35.56	38.10
009	40.64	43.18
010	45.72	48.26
011	50.80	53.34
012	55.88	58.42
013	60.96	63.50
014	66.04	68.58
015	71.12	73.66
016	76.20	78.74
017	81.28	83.82
018	86.36	88.90
019	91.44	93.98
020	96.52	99.06

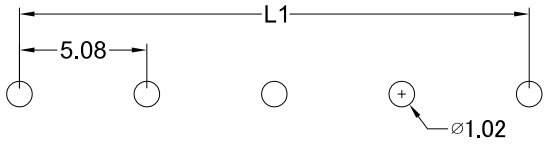
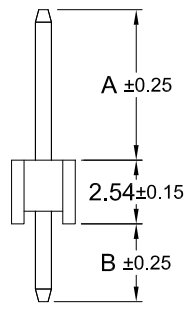
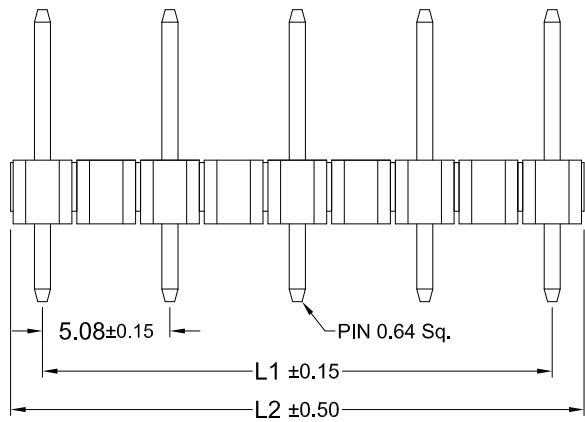
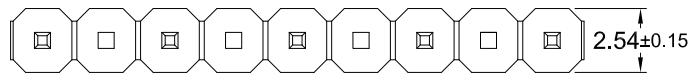

Recommended PCB Hole Layout  
(PCB TOLERANCE ±0.05)

REV.	DESCRIPTION	DATE	DRAWN
A	NEW	24.06.2005	Linda
B	Add Pin Coed "140/14"	25.02.2013	Ryan
C	update pin coed	28.01.2016	Ryan

Order Code  
**SL1-xxx-S xxx/xx-xx/5**

No. of Pin  
**002 to 020**

Pin Type  
See Table on sheet 2/2

Plating  
**55** = Gold flash (Standard)  
**66** = 10µ" Gold  
**77** = 15µ" Gold  
**88** = 30µ" Gold  
**99** = Tin  
 Duplex plating  
**95** = Tin/Gold flash  
**96** = Tin/10µ" Gold  
**97** = Tin/15µ" Gold  
**98** = Tin/30µ" Gold

Execution  
 P.B.T Insulator (standard) = **S**  
 High Temp Insulator = **SH**

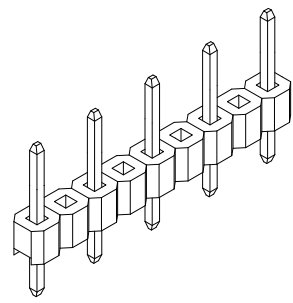

**Materials**

Insulator Material: PBT or High Temp Thermoplastic  
 Color: Black, UL 94V-0  
 Contact Material: Brass  
 Plating: Gold, Tin or Duplex  
 \*Duplex = Tin on solder area, Gold plated on contact area  
 Operating Temperature: -40° ~ +105°C

**Specifications**

**Electrical**

Current Rating: 3A  
 Insulator resistance: 1000 MΩ min.  
 Contact Resistance: 20 mΩ max.  
 Dielectric Withstanding: AC 500V/Minute

E-tec 2015 © - all rights reserved



UNIT	SCALE	GENERAL TOLERANCE	DRAWN	DATE	DWG. NO.	SHEET
mm	Free	X.° ± X. ±	Linda	24.06.2005	SL1-Sxxx/xx/5	1/2
		.X° ± .X ±	Kent	28.01.2016	SERIES NO.	REV. C
		.XX° ± .XX ± 0.25	SH	28.01.2016	SL1-xxx-Sxxx/xx-xx/5	
		.XXX° ± .XXX ±				

**5.08mm Pitch Pin Header**  
 (2.54mm pitch insulator Void even pin)  
 -THT- Straight

	1	2	3	4	5	6	7	8							
A	Pin-Code	Dim."A" (mm)	Dim."B" (mm)	Pin-Code	Dim."A" (mm)	Dim."B" (mm)	Pin-Code	Dim."A" (mm)	Dim."B" (mm)	Pin-Code	Dim."A" (mm)	Dim."B" (mm)	Pin-Code	Dim."A" (mm)	Dim."B" (mm)
	076/03	2.00	3.10	140/10	5.70	5.80	167/01	7.10	7.10	155/08	10.00	3.00	198/02	14.00	3.30
	069/01	2.20	2.20	184/12	5.70	10.20	112/01	7.16	1.50	180/08	10.00	5.50	198/01	14.30	3.00
	060/01	2.50	1.00	209/03	5.70	12.70	125/13	7.20	2.80	190/05	10.00	6.50	204/01	14.90	3.00
	079/01	2.70	2.70	216/01	5.70	13.40	128/03	7.30	3.00	209/04	10.20	8.20	219/01	14.90	4.50
	085/01	2.70	3.30	240/01	5.70	15.75	115/02	7.50	1.50	184/03	10.50	5.11	200/03	15.00	2.54
	083/01	2.90	2.90	267/01	5.70	18.50	125/02	7.50	2.54	163/02	10.70	3.10	210/05	15.46	3.00
	085/02	3.00	3.00	106/02	5.80	2.30	126/03	7.50	2.60	184/07	10.70	5.11	216/08	16.00	3.10
	088/01	3.00	3.30	108/01	5.80	2.50	136/07	7.50	3.60	155/06	10.80	2.20	245/03	16.00	6.00
	186/03	3.20	12.90	113/02	5.80	3.00	175/02	7.50	7.50	159/06	10.80	2.54	216/06	17.11	1.95
	257/01	3.20	20.00	116/07	5.80	3.30	123/02	7.60	2.20	165/01	10.80	3.20	228/01	17.30	3.00
	091/01	3.30	3.30	185/03	5.80	10.20	134/01	7.70	3.20	164/02	10.90	3.00	175/01	17.50	3.30
	076/01	3.40	2.70	312/04	5.80	22.90	184/11	7.90	7.90	163/01	10.96	2.80	233/01	17.80	3.00
	090/02	3.50	3.00	141/01	5.84	5.72	125/08	8.00	1.80	165/03	11.00	3.00	261/01	17.80	5.80
	140/08	3.50	7.90	100/01	6.00	1.50	135/05	8.00	2.80	168/01	11.00	3.30	286/02	17.90	8.20
	090/01	3.66	2.80	105/04	6.00	2.00	135/08	8.00	3.00	178/03	11.00	4.30	235/04	18.00	3.00
	105/03	3.70	4.30	110/03	6.00	2.50	140/13	8.00	3.50	167/02	11.20	3.00	408/01	18.00	20.30
	108/14	3.70	4.00	113/05	6.00	2.80	137/01	8.10	3.10	185/05	11.20	4.80	290/09	18.46	8.00
	093/01	3.80	3.00	116/01	6.00	3.10	164/04	8.10	5.80	184/08	11.60	4.30	210/10	18.50	0.00
	085/08	4.00	2.00	140/06	6.00	5.40	191/03	8.10	8.50	172/01	11.70	3.00	240/02	18.50	3.00
	095/02	4.00	3.00	108/09	6.10	2.16	135/04	8.13	2.79	176/02	11.80	3.30	249/01	18.90	3.50
	095/01	4.20	2.80	109/04	6.10	2.30	138/01	8.16	3.10	177/07	11.85	3.35	245/01	19.00	3.00
	105/05	4.20	3.60	147/06	6.10	6.10	135/10	8.20	2.80	177/01	12.00	3.20	405/01	20.00	18.00
	108/13	4.20	4.10	118/02	6.26	3.00	140/12	8.20	3.30	178/01	12.30	3.00	260/05	20.50	3.00
	108/10	4.30	4.00	108/03	6.30	2.00	138/02	8.30	3.00	184/10	12.30	3.60	266/03	21.10	3.00
	097/01	4.50	2.70	113/04	6.30	2.54	140/07	8.30	3.15	271/01	12.30	12.30	345/02	24.00	8.00
	100/07	4.50	3.00	113/06	6.50	2.30	135/02	8.50	2.50	177/02	12.40	2.80	300/01	24.20	3.30
	108/07	4.50	3.80	120/05	6.50	3.00	140/03	8.50	3.00	186/01	12.40	3.80	335/01	25.00	6.00
	118/04	4.50	4.80	109/05	6.60	1.80	195/03	8.50	8.50	180/06	12.46	3.00	313/01	26.00	2.80
	125/05	4.80	5.11	118/01	6.60	2.70	140/14	8.70	2.80	218/02	12.50	6.80	316/03	26.06	3.00
	085/03	5.00	1.00	123/01	6.60	3.20	143/02	8.80	3.00	184/02	12.60	3.00	320/01	26.46	3.00
	100/04	5.00	2.50	125/10	6.60	3.40	147/09	8.90	3.30	185/01	12.70	3.30	355/01	30.00	2.90
	105/01	5.00	3.00	121/01	6.70	2.90	115/03	9.00	0.00	203/01	12.70	5.11	340/05	34.00	4.00
	108/12	5.00	3.30	125/04	6.70	3.30	140/02	9.00	2.54	184/06	12.80	3.10			
	102/02	5.20	2.50	159/03	6.70	6.70	147/05	9.00	3.00	216/07	12.80	6.30			
	108/04	5.30	3.00	122/01	6.71	3.00	180/07	9.00	6.50	184/01	12.90	3.00			
	109/03	5.40	3.00	126/01	6.80	3.30	143/01	9.20	2.60	345/01	12.90	19.00			
	117/01	5.40	3.80	138/03	6.80	4.50	142/01	9.30	2.40	185/04	13.00	3.00			
	108/11	5.50	2.80	125/15	6.90	3.10	145/03	9.40	2.60	162/02	13.20	3.00			
	116/02	5.50	3.30	110/02	7.00	1.50	140/04	9.50	2.00	209/02	13.30	5.11			
	120/04	5.50	4.00	116/05	7.00	2.00	147/12	9.50	2.70	270/01	13.49	11.00			
	108/02	5.70	2.54	125/01	7.00	3.00	137/04	9.60	1.60	185/08	13.70	2.30			
	125/03	5.70	4.30	135/03	7.00	4.00	154/03	9.60	3.30	188/01	14.00	2.30			
	135/01	5.70	5.30	147/02	7.00	5.11	155/01	9.80	3.15	195/01	14.00	3.00			
	139/01	5.70	5.70												

E-tec 2015 © - all rights reserved



UNIT mm	GENERAL TOLERANCE		DRAWN Linda	DATE 24.06.2005	DWG. NO. SL1-Sxxx/xx/5	SHEET 2/2	
	X.° ±	X. ±					
	SCALE Free	.X° ±	.X ±	CHECK Kent	DATE 28.01.2016	SERIES NO. SL1-xxx-Sxxx/xx-xx/5	REV. C
		.XX° ±	.XX ± 0.25				
	.XXX° ±	.XXX ±	APPROVE SH	DATE 28.01.2016			

**Pin Coed Sheet**  
**5.08mm Pitch Pin Header**  
*(2.54mm pitch insulator Void even pin)*  
**-THT- Straight**