

1.27mm pitch Female Header

- SMT- side entry

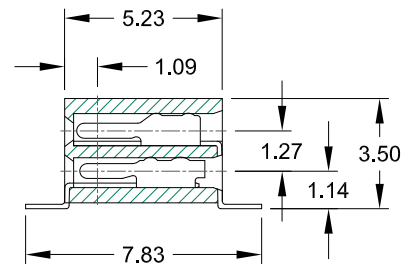
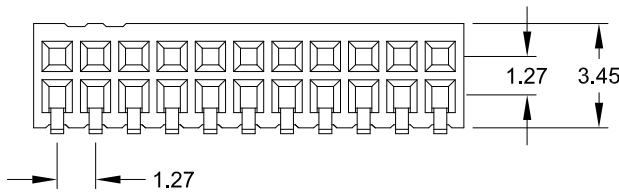
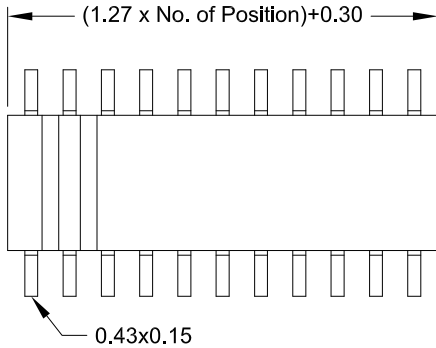
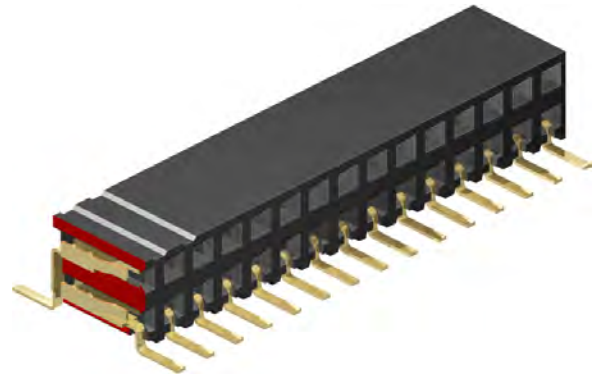

Application and Features

- **Standard: Tube packing**
- Hi-rel dual beam contact assures reliable PC-Board connections
- Accepts 0.40mm square pins; Pin Header 1.27mm x 1.27 mm
- 3.50mm height above board
- Automatic assembly to PCB possible

PCB Surface Mount Layout

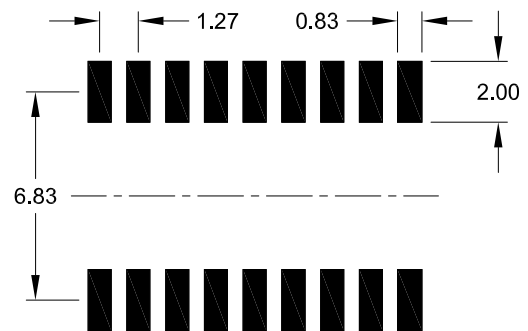

Specifications

Current rating	1 A	Operating temperature	- 40°C to +105°C
Insulation resistance	1000 MΩ min.	Processing temperature	+250°C +0/-5°C for 5sec.
Contact resistance	20 mΩ max.	Contact material	(RoHS compliant) Phosphor Bronze
Withstanding voltage	500 V AC	Insulator material	(RoHS compliant) LCP UL 94 V-0

How to order

BS2 - xxx - R345 - 55/11 X

