

1.00mm pitch Pin Header  
 - THT - dual row straight

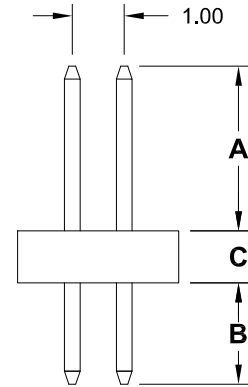
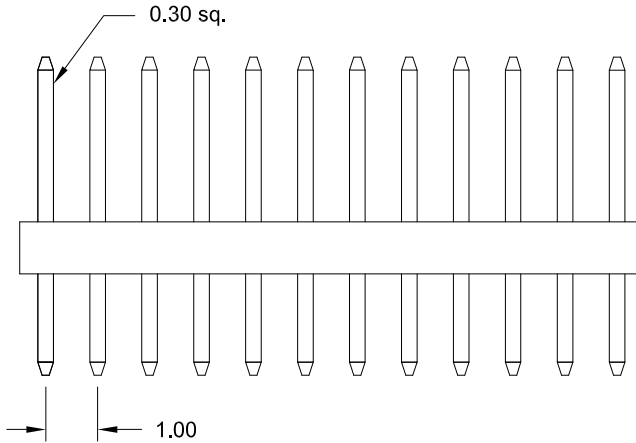
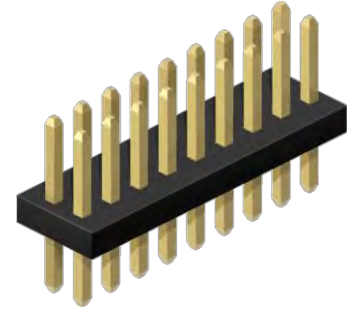
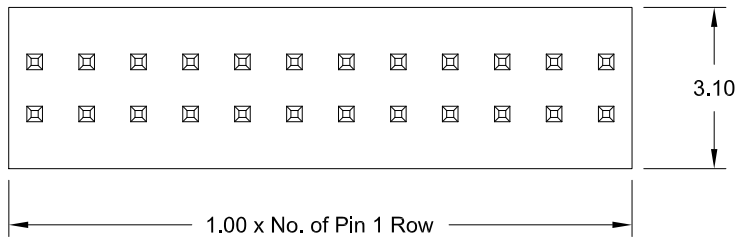

**Specifications**

Current rating	1 A
Insulation resistance	1000 MΩ min.
Withstanding voltage	500 V AC
Operating temperature	- 40°C to +105°C
Contact material	(RoHS compliant) Copper Alloy
Insulator material	(RoHS compliant) PA9T UL 94 V-0

**PCB Hole Layout**

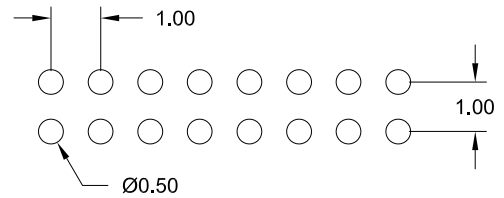

How to order

SL2 - xxx - S xxx/x - 55/00

Nbr of pins
004 to 080

Pin code	DIM "A"	DIM "B"	DIM "C"
050/1	2.00 mm	2.00 mm	1.00 mm
050/2	3.20 mm	2.30 mm	1.00 mm
050/3	3.00 mm	2.30 mm	1.00 mm
112/1	6.50 mm	3.20 mm	1.50 mm
other dimensions on request			

Plating
55 = Gold
other platings on request