

REV.	DESCRIPTION	DATE	DRAWN
A	New	14.11.2006	RH
C	correct No. of contact	20.04.2011	Ronny
D	7.40->9.43, Ø0,60->Ø0,64, 5,58->6.04	06.08.2018	RH
E	update	09.08.2019	Ronny

**Order Code**  
**SHM-xxx-FIP7-55/B1TXX**

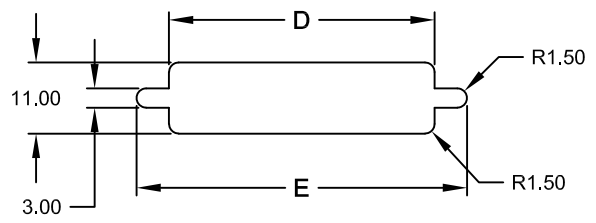
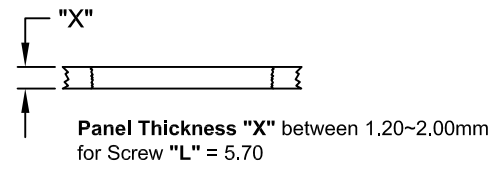
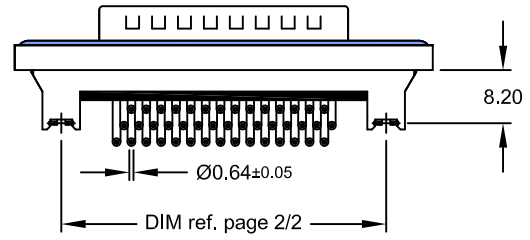
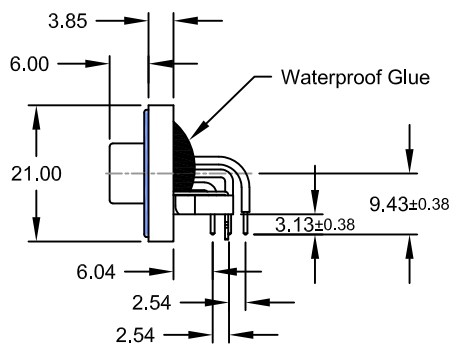
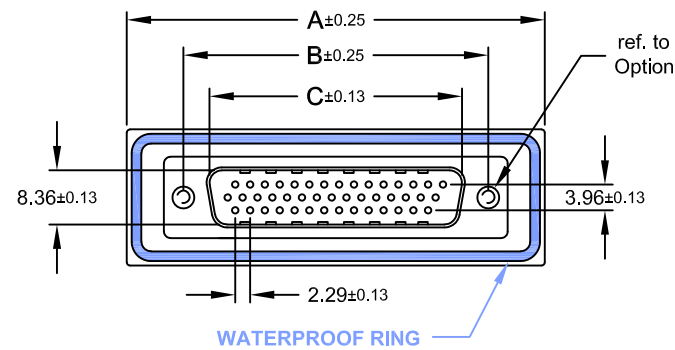

Recommended Panel CUT-OUT

Dimension mm					No. of Contact
A	B	C	D	E	
39,40	24,99	16,92	20,00	28,20	<b>015</b>
47,70	33,30	25,25	28,00	36,50	<b>026</b>
64,50	47,04	38,96	41,50	51,00	<b>044</b>

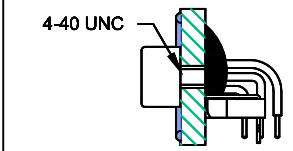
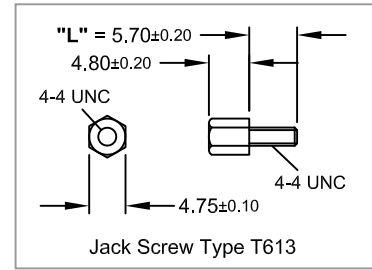

Option: **T**

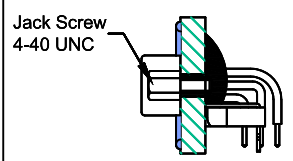

Option: **TJ**  
*(Jack Screws mounted)*

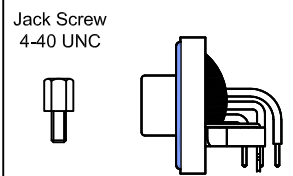

Option: **TJS**  
*(Jack Screws bulk packed)*



**Specifications**

**Electrical**  
 Current rating: 5A  
 Insulation resistance: 5000MΩ min.  
 Contact resistance: 10mΩ max.  
 Withstanding voltage: 1000V AC rms

**Material**  
 Contact: Brass  
 Plating: Au flash over Ni  
 Insulator: PBT UL 94V-0  
 Shell: Steel  
 Plating: Ni  
 Operating temperature: -55°C to +85°C

Salt Spray: 48 Hours  
 Waterproof Rate: IP 67 min.

E-tec 2019 © - all rights reserved

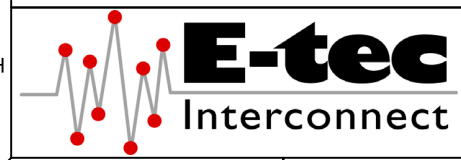

UNIT	GENERAL TOLERANCE		DRAWN	DATE
mm	X.° ±	X. ±	RH	14.11.2006
SCALE	.X° ±	.X ±	CHECK	DATE
Free	.XX° ±	.XX ± 0.25	Ronny	09.08.2019
	.XXX° ±	.XXX ±	APPROVE	DATE
			Fagi	09.08.2019

DWG. NO.	SHEET 1/2
SHM-FIP7/B1T	REV. E
SERIES NO.	
SHM-xxx-FIP7-55/B1TXX	

**Waterproof D-Sub**  
 High Density "Male"  
*Right Angle Type with Brackets*

REV.	DESCRIPTION	DATE	DRAWN
A	New	14.11.2006	RH
B	frame	23.07.2008	Ronny
C	general update	06.08.2018	RH
D	update	09.08.2019	Ronny

# RECOMMENDED PCB HOLE LAYOUT "MALE"

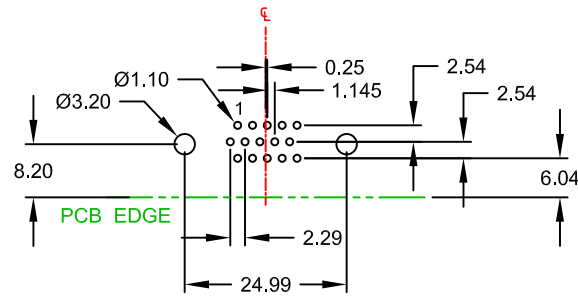

15-contact

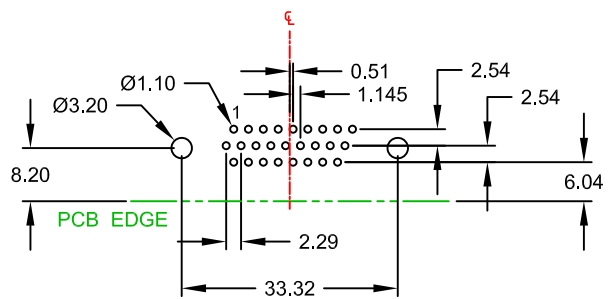

26-contact

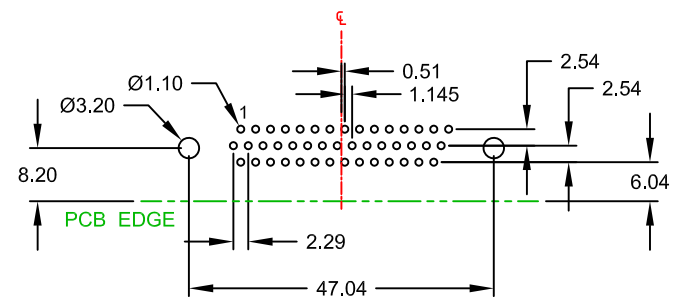

44-contact

Layout Top View  
(Tolerance ±0.05)

E-tec 2019 © - all rights reserved



UNIT mm	GENERAL TOLERANCE		DRAWN RH	DATE 14.11.2006	DWG. NO. SHM-FIP7/B1T	SHEET 2/2								
	X.° ±	X. ±												
	.XX° ±	.XX ± 0.25												
	.XXX° ±	.XXX ±												
SCALE Free	APPROVE Fagi	DATE 09.08.2019	DATE 09.08.2019	SERIES NO. SHM-xxx-FIP7-55/B1TXX	REV. D									
							CHECK Ronny	DATE 09.08.2019	DATE 09.08.2019					
												DATE 09.08.2019		

**PCB Hole Layout for**  
Waterproof D-Sub  
High Density "Male"  
*Right Angle Type with Brackets*