

| REV. | LOCAS. | DESCRIPTION                | DATE       | DRAWN |
|------|--------|----------------------------|------------|-------|
| A    |        | RoHS                       | 13.07.2006 | Ronny |
| B    |        | update description         | 02.02.2011 | Ronny |
| C    |        | add plckup tape; PN add /R | 18.02.2011 | Ronny |
| D    |        | New DWG. No.               | 01.02.2012 | Ronny |

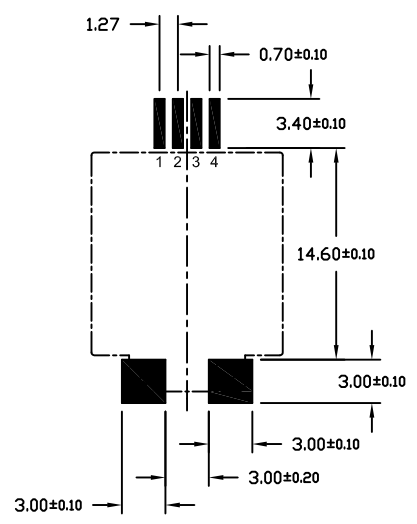
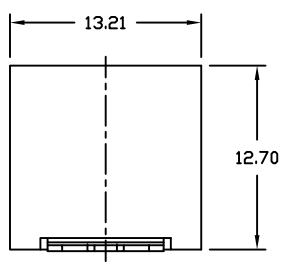
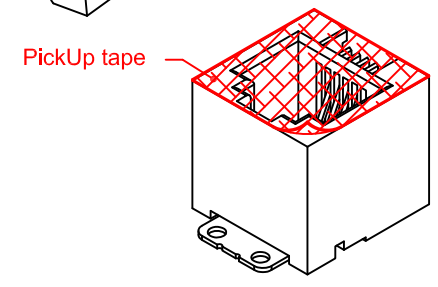
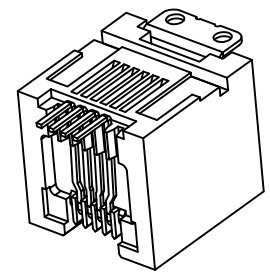
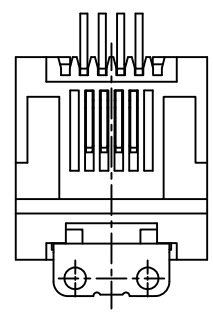
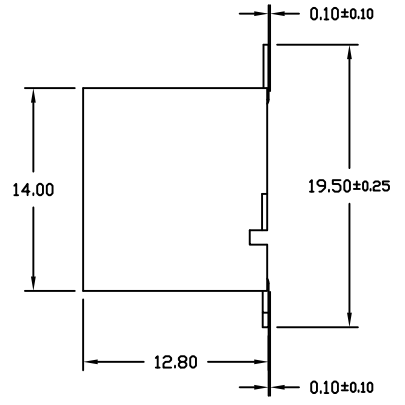
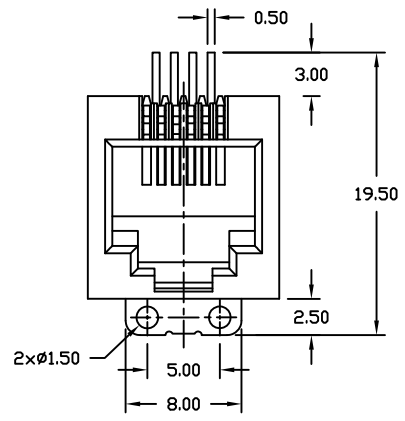

RECOMMENDED PCB LAYOUT

- NOTE :
- MATERIAL: HI TEMP THERMOPLASTIC UL94V-0  
STANDARD COLOR-BLACK  
CONTACT-PHOSPHOR BRONZE; 0.35mm THICK  
SELECTIVE GOLD/TIN PLATED OVER Ni  
HOLD DOWN: COPPER ALLOY; 0.40mm THICK  
TIN OVER NICKEL
  - ENVIROMENTAL:  
OPERATING TEMPERATURE: -20°C TO +85°C  
PROCESSING TEMPERATURE:  
+230°C FOR 60 SEC. max.  
+260°C -5/+0 FOR 5 SEC max.
  - ELECTRICAL:  
CURRANT RATING: 1,5A max. (@25°C)  
VOLTAGE RATING: 150V AC max.  
CONTACT RESISTANCE: 15mΩ max.  
DIELECTRIC WITHSTANDING VOLTAGE:  
1000V rms 1 MINUTE (60Hz)  
INSULATION RESISTANCE:  
500MΩ min.
  - CAVITY CONFIRMS TO FCC RULES AND  
REGISTRATION PAR68, SUBPARTS F.
  - PACKING: REEL

| PART NUMBER       | GOLD PLATING CONTACT AREA |
|-------------------|---------------------------|
| MJT-164-T1S0-96/R | 6μ"                       |
| MJT-164-T1S0-97/R | 15μ"                      |
| MJT-164-T1S0-98/R | 30μ"                      |
| MJT-164-T1S0-9H/R | 50μ"                      |



|       |      |                   |        |         |       |      |            |            |                   |           |
|-------|------|-------------------|--------|---------|-------|------|------------|------------|-------------------|-----------|
| UNIT  | mm   | GENERAL TOLERANCE |        | DRAWN   | Ronny | DATE | 13.07.2006 | DWG. NO.   | 1811400           | SHEET 1/1 |
| SCALE | Free | X.° ±             | X. ±   | CHECK   | Ronny | DATE | 01.02.2012 | SERIES NO. | MJT-16x-T1S0-xx/R | REV. D    |
|       |      | .XX° ±            | .XX ±  | APPROVE | Hogi  | DATE | 01.02.2012 |            |                   |           |
|       |      | ANG ± 0,5°        | .XXX ± |         |       |      |            |            |                   |           |

SMT PCB Jack RJ14 <6P4C>  
Top Entry  
NON Schielded

|      |             |            |        |
|------|-------------|------------|--------|
| REV. | DESCRIPTION | DATE       | DRAWN  |
| A    | NEW         | 29.03.2016 | Cherry |

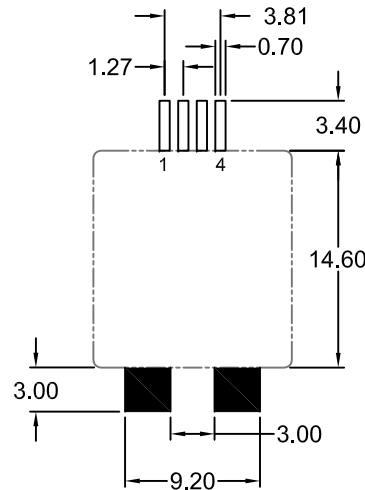
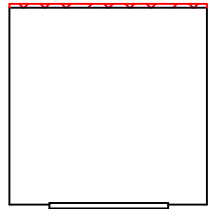
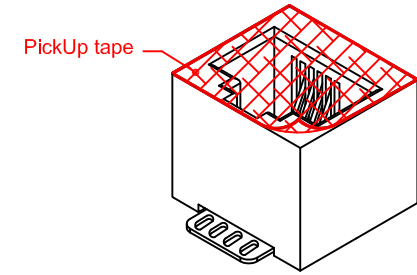
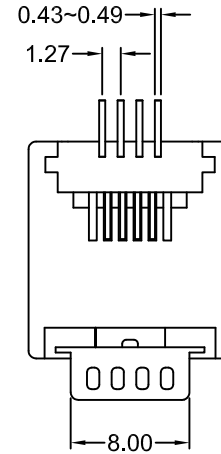
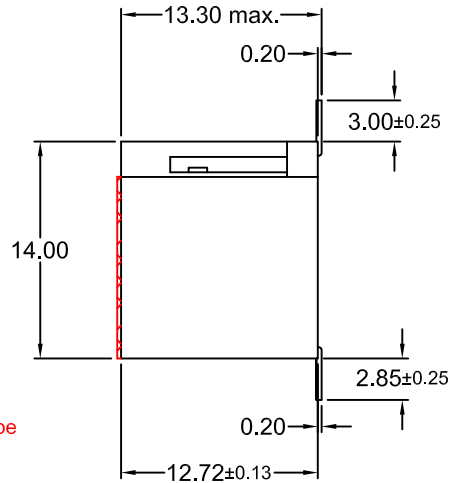
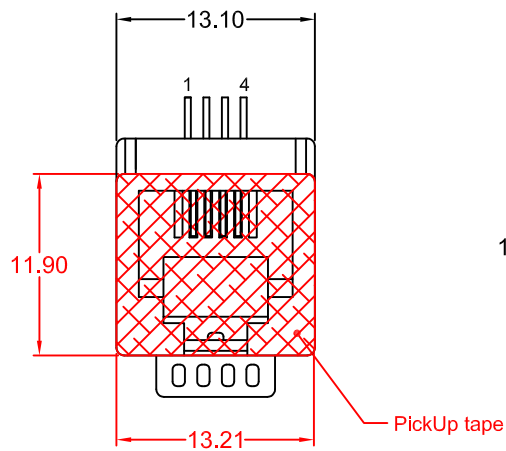

Recommended PCB Hole Layout  
(Top View)

### Specifications

#### Electrical

Current rating: 1.5A  
 Insulation resistance: 500MΩ min.  
 Withstanding voltage: 1000V rms 60Hz / Minute  
 Contact resistance: 50mΩ max.  
 Operating temperature: -40°C to +85°C

#### Material

Contact: Phosphor Bronze (t=0.35mm)  
 Plating: Au in solder area; Au in contact area  
 Housing: PA9T UL 94V-0 (Black )  
 Insert: PA46 UL 94V-0 (Black )

Cavity conforms to FCC Rules and Registration PAR68,  
 Subparts F

#### Packing

Reel



| PART NUMBER       | GOLD PLATING CONTACT AREA |
|-------------------|---------------------------|
| MJT-164-T3S0-55/R | 3μ"                       |
| MJT-164-T3S0-56/R | 6μ"                       |
| MJT-164-T3S0-57/R | 15μ"                      |
| MJT-164-T3S0-58/R | 30μ"                      |
| MJT-164-T3S0-5H/R | 50μ"                      |



|       |      |
|-------|------|
| UNIT  | mm   |
| SCALE | Free |
|       |      |

| GENERAL TOLERANCE |            |
|-------------------|------------|
| X.° ±             | .X° ±      |
| X. ±              | .X ±       |
| XX. ±             | .XX ± 0.13 |
| XXX. ±            | .XXX ±     |

|         |        |      |            |
|---------|--------|------|------------|
| DRAWN   | Cherry | DATE | 29.03.2016 |
| CHECK   | Hogi   | DATE | 29.03.2016 |
| APPROVE | Hogi   | DATE | 29.03.2016 |

|            |                   |       |     |
|------------|-------------------|-------|-----|
| DWG. NO.   | 1811401           | SHEET | 1/1 |
| Series NO. | MJT-164-T3S0-xx/X | REV.  | A   |

**SMT PCB Jack RJ14 <6P4C>**  
 Top Entry  
 NON shielded