

REV.	DESCRIPTION	DATE	DRAWN
A	NEW	17.11.2014	Ryan
B	Correct Layout	16.12.2014	Ryan

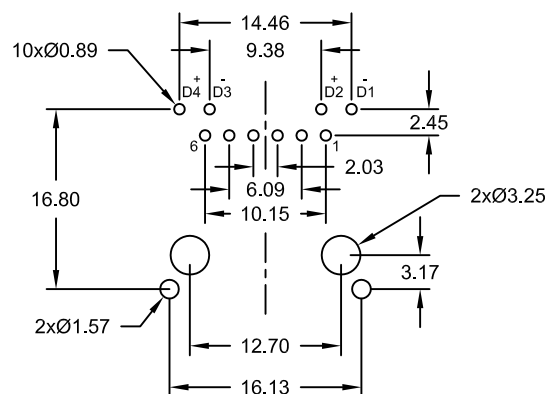

Recommended PCB Hole Layout Top View
(Tolerance: ± 0.05)

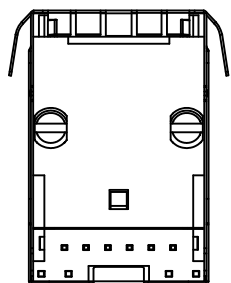
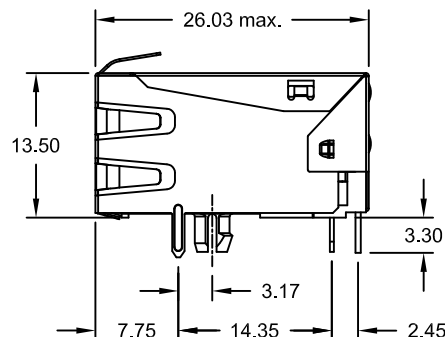
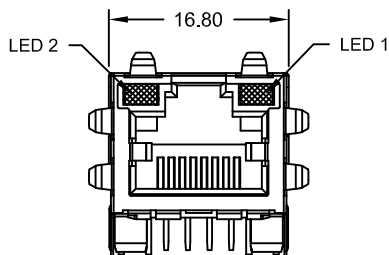
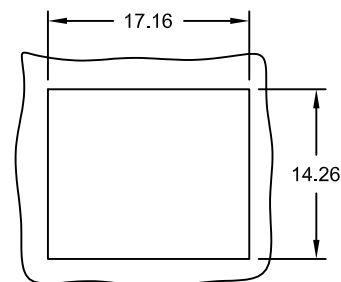
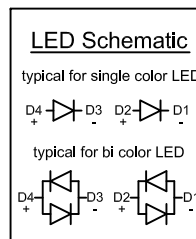

Recommended Panel Cutout

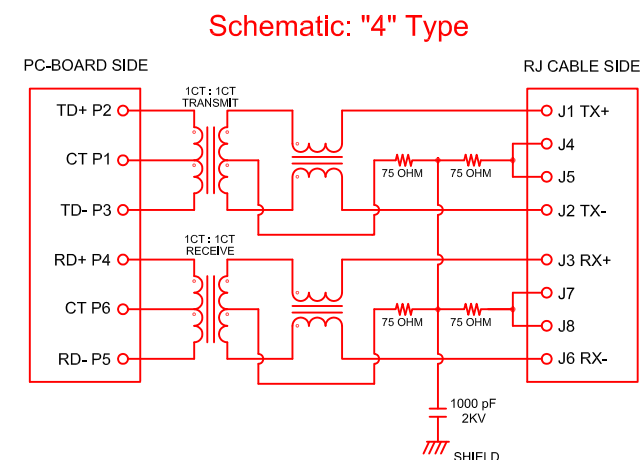

ELECTRICAL CHARACTERISTICS

Test Notes: (25°C $\pm 5^\circ\text{C}$)

- TR: (100KHz 0.1V):
Pins: (P1-P3):(J1-J2)=1:1 $\pm 3\%$
Pins: (P4-P6):(J3-J6)=1:1 $\pm 3\%$
- LX: (100KHz 100mV 8mA DC Bias)
Pins: (P1-P3):(P4-P6)=350 μH min.
- DCR:
Pins: (J1-J2):(J3-J6)=1.2 Ω max.
- HIPOT:
Pins: (P1,P2,P3)to(J1,J2)=1500V AC for 60 Sec.
Pins: (P4,P5,P6)to(J3,J6)=1500V AC for 60 Sec.
- INSERTION LOSS:
-1dB max. at 0.3MHz to 100MHz
- RETURN LOSS:
-20dB min. at 1MHz to 30MHz
-15dB min. at 30MHz to 60MHz
-10dB min. at 60MHz to 80MHz
- CROSS TALK:
-30dB min. at 1MHz to 100MHz
- COMMON TO COMMON MODE REJECTION:
-30dB min. at 1MHz to 100MHz

SPECIFICATION

- MATERIAL:
Housing - PBT UL 94V-0 (black)
Contact - 0.35mm Copper Alloy; Sn/Au plated
Shield - Brass; Ni plated
- OPERATING LIFE: 750 Cycles min.
- TEMPERATURE RANGE:
Operating -40°C to 85°C
- Cavity confirms to FCC rules and regulations Part 68, Subpart F



PART NUMBER	GOLD PLATING CONTACT AREA
MJS-186-MCL4-96/SxCA	6 μm
MJS-186-MCL4-97/SxCA	15 μm
MJS-186-MCL4-98/SxCA	30 μm
MJS-186-MCL4-9H/SxCA	50 μm

Replace "x" with
LED Color Options

	LED 2	LED 1
1	YELLOW	GREEN
2	NO LED	GREEN
3	GREEN	NO LED
4	GREEN	YELLOW
5	GREEN	GREEN
6	YELLOW	YELLOW
7	ORANGE/GREEN	ORANGE/GREEN
8	YELLOW/GREEN	YELLOW/GREEN
9	RED	NO LED
A	GREEN/YELLOW	GREEN/YELLOW
B	RED/GREEN	RED/GREEN
C	RED/GREEN	GREEN/YELLOW
D	GREEN	GREEN/YELLOW
E	YELLOW	GREEN/YELLOW

UNIT	mm	GENERAL TOLERANCE		DRAWN	DATE	DWG. NO.	SHEET 1/1
SCALE	Free	X.° \pm	X. \pm	Ryan	17.11.2014	1342532	REV. B
		.X° \pm	.X ± 0.25	Ronny	16.12.2014	SERIES NO.	
		.XX° \pm	.XX ± 0.15	Hogi	16.12.2014	MJS-186-MCL4-9x/SxCA	
		.XXX° \pm	.XXX ± 0.075				



RJ45 PCB JACK <8P/6C> Tab up
side entry, long profile Type with LED
fully shielded with GROUNDING TABS
"4" Type 10/100 Mbps, 4 core TX Filtered