

REV.	LOCAS.	DESCRIPTION	DATE	DRAWN
A		NEW	17.02.1994	KATHY
B		update description	24.01.2011	Ronny
C		New DWG. No.	01.02.2012	Ronny

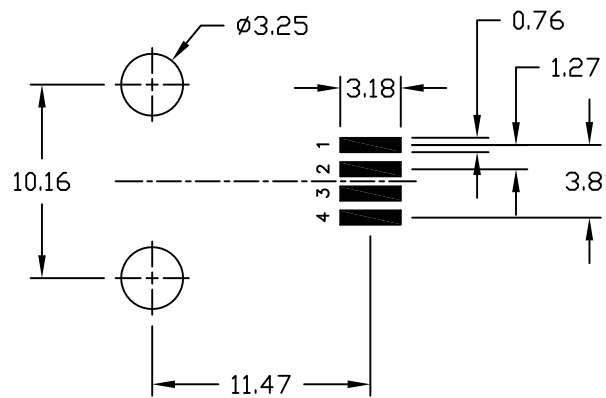

PCB LAYOUT TOP VIEW

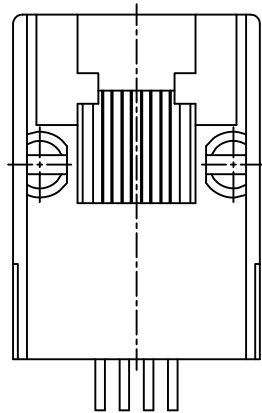
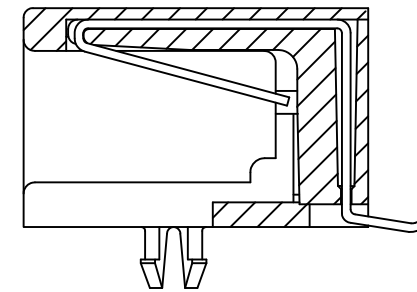
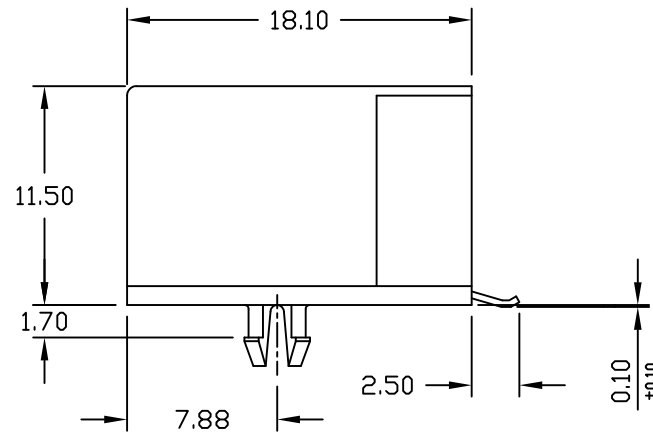
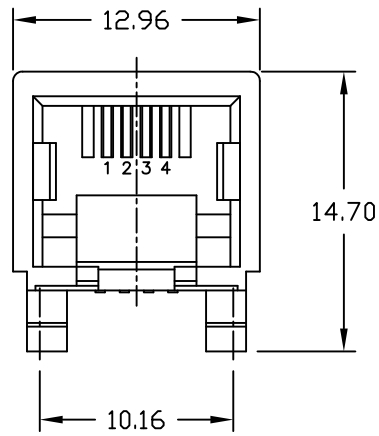

NOTE

- Material:
Housing: Nylon UL 94V-0
Contact: Phosphor Bronze
Contact plating: Sn over Ni on solder area
Au over Ni on contact area
- Electrical:
Current rating: 1.5A max. @ 25°C
Voltage rating: 150V AC max.
Contact resistance: 15mΩ max.
Dielectric withstanding Voltage:
1000V rms 1 Minute 60Hz
Insulation resistance: 500MΩ min.
- Environmental:
Operating temperature: -20°C to +85°C
Processing temperature: 250°C ± 0/-5°C
for 10 seconds

PART NUMBER	GOLD PLATING CONTACT AREA
MJS-164-T1S0-96	6μ"
MJS-164-T1S0-97	15μ"
MJS-164-T1S0-98	30μ"
MJS-164-T1S0-9H	50μ"



UNIT	mm	GENERAL TOLERANCE		DRAWN	Kathy	DATE	17.02.1994	DWG. NO.	1711400	SHEET 1/1
SCALE	Free	X.° ± 5°	X. ± 0.30	CHECK	Ronny	DATE	01.02.2012	SERIES NO.	MJS-1xx-T1S0-9x	REV. C
		.XX° ± 3°	.X ± 0.25	APPROVE	Hogi	DATE	01.02.2012			
		.XXX° ± 1°	.XXX ± 0.10							

SMT PCB JACK SIDE ENTRY
RJ14 <6P4C>
UNSHIELDED

REV.	DESCRIPTION	DATE	DRAWN
A	New	15.01.2010	Lyndon
D	update description	26.01.2011	Ryan
E	New DWG. No.	01.02.2012	Ryan
F	update Specifications&add color option	16.11.2016	Cherry

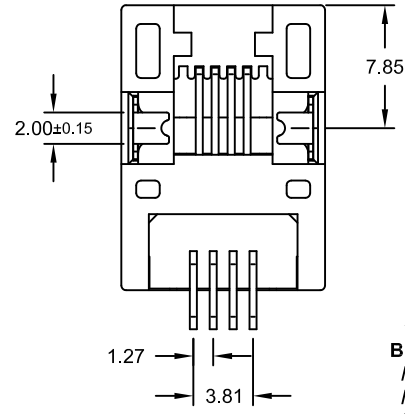
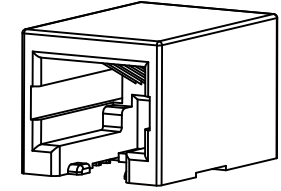
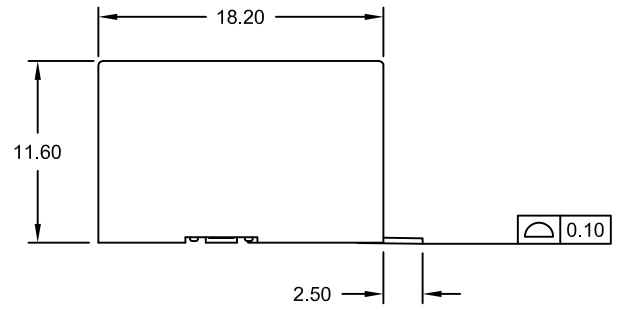
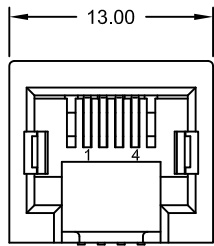

Color & Packing option

- Blank = black & Tray Packing
- /R = black & Reel Packing
- /G = gray & Tray Packing
- /GR = gray & Reel Packing
- /Y = yellow & Tray Packing
- /YR = yellow & Reel Packing

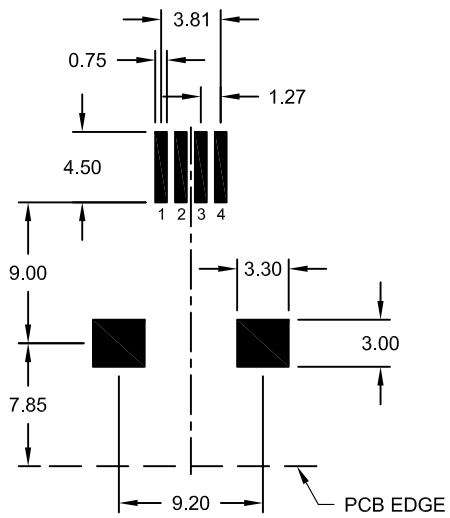

Recommended PCB Layout Top View
(Tolerance ±0.05)



Specifications

Electrical

- Current rating: 1.5A
- Insulation resistance: 500MΩ min.
- Contact resistance: 50mΩ max.
- Withstanding voltage: 1000V AC / Minute

Materials

- Contact: Copper Alloy t=0.35mm
- Plating: Sn on solder area,
Au on contact area;
entire contact Ni underplated
- Solder Tab: Copper Alloy, Nickel plated
- Insulator: LCP (Black, gray or yellow) UL 94V-0

- Operating temperature: -40°C to +85°C
- Processing temperature: 250°C +0/-5°C
for 10 seconds

Cavity comply with FCC Rules and
Regulations Part 68, Subpart F

PART NUMBER	GOLD PLATING CONTACT AREA
MJS-164-U0M0-95 /XX	flash
MJS-164-U0M0-96 /XX	6μ"
MJS-164-U0M0-97 /XX	15μ"
MJS-164-U0M0-98 /XX	30μ"
MJS-164-U0M0-9H /XX	50μ"

E-tec 2016 © - all rights reserved



UNIT	GENERAL TOLERANCE		DRAWN	DATE	DWG. NO.	SHEET 1/1
mm	X.° ±	X. ±	Lyndon	15.01.2010	1711401	REV.F
SCALE	.X° ±	.X ±	CHECK	DATE	SERIES NO.	
Free	.XX° ±	.XX ± 0.25	Ronny	16.11.2016	MJS-164-U0M0-9x/X	
	.XXX° ±	.XXX ±	APPROVE	DATE		
			Hogi	16.11.2016		

Side Entry SMT PCB Jack
RJ14 <6P4C> non shielded
solder tabs underneath housing

REV.	DESCRIPTION	DATE	DRAWN
A	NEW / New Frame 05.03.2009 Ronny	31.01.2002	RH
B	update: Nylon FR52 => Nylon 9T	18.02.2014	Ronny

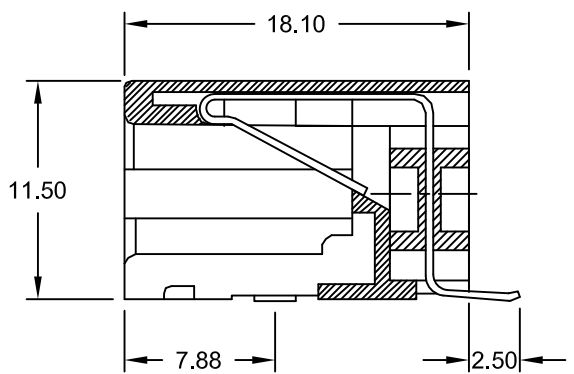
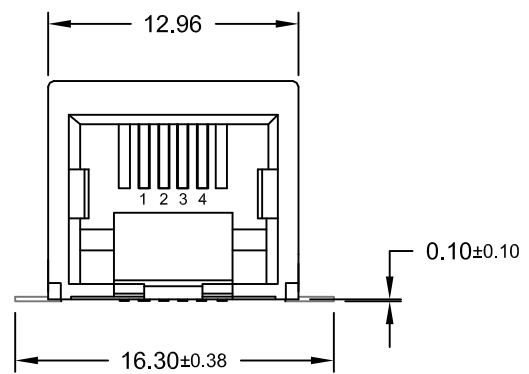

Specifications
Electrical

Current rating: 1.5A max. (@25°C)
 Insulation resistance: 1000MΩ min. @500V DC
 Voltage rating: 125V AC rms
 Withstanding voltage: 1000V AC rms / 1 Minute (60Hz)
 Contact resistance: 30mΩ max.

Material

Contact: Phosphor Bronze t=0.35mm
 Plating: Sn over Ni in solder area
 Au over Ni in contact area
 Housing: Nylon 9T UL 94V-0 (Black)

Storage temperature: -40°C to +85°C
 Operating temperature: -0°C to +70°C
 Processing temperature: +250°C +0/-5°C
 for 10 seconds

Cavity conforms to FCC Rules and Registration PAR68
 Subparts F

Mechanical Requirements

Operating life: 750 cycles min.

Packing

Tray Standard; Reel Option

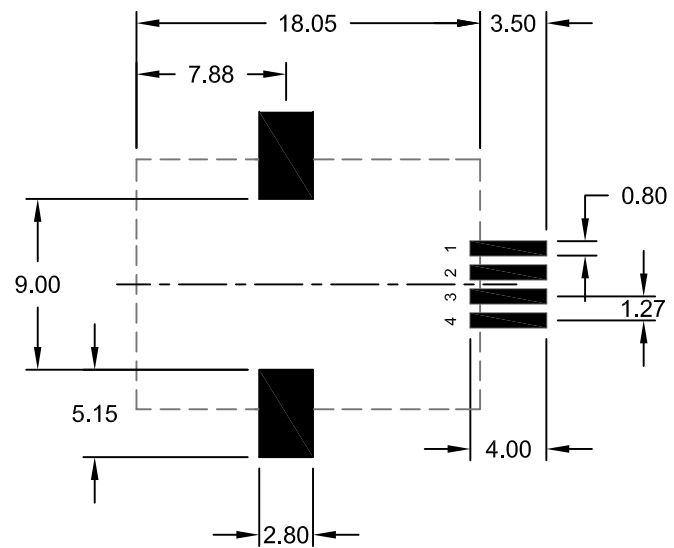
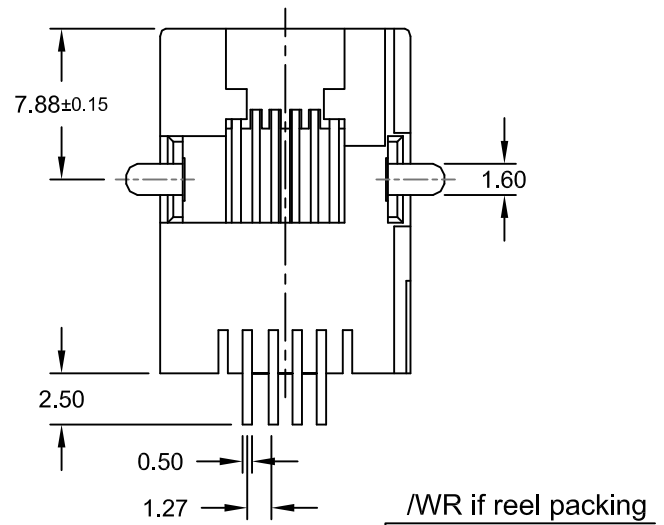

Recommended PCB Layout
(Top View)

PART NUMBER	GOLD PLATING CONTACT AREA
MJS-164-T3004-96/W	6μ"
MJS-164-T3004-97/W	15μ"
MJS-164-T3004-98/W	30μ"
MJS-164-T3004-9H/W	50μ"

/WR if reel packing



UNIT	SCALE	GENERAL TOLERANCE	DRAWN	DATE	DWG. NO.	SHEET 1/1
mm	Free	X.° ±	RH	31.01.2002	1711402	REV. B
		.X° ±	Ronny	18.02.2014	SERIES NO.	
		.XX° ±	Hogi	18.02.2014	MJS-164-T3004-xx/X	
		ANG. ± 3°				

SMT PCB JACK SIDE ENTRY
 RJ14 "W" Type <6P4C>
 non shielded

REV.	DESCRIPTION	DATE	DRAWN
A	New	04.03.2016	Ryan

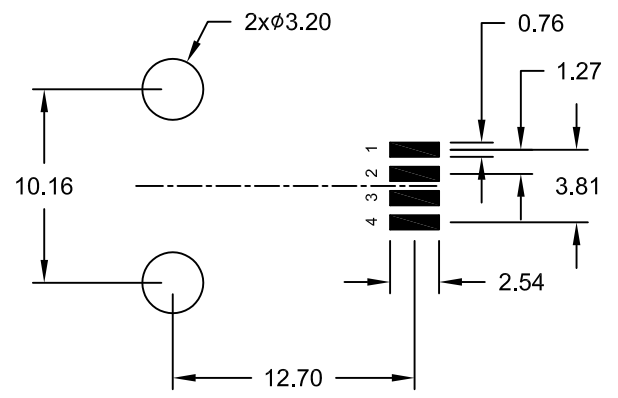
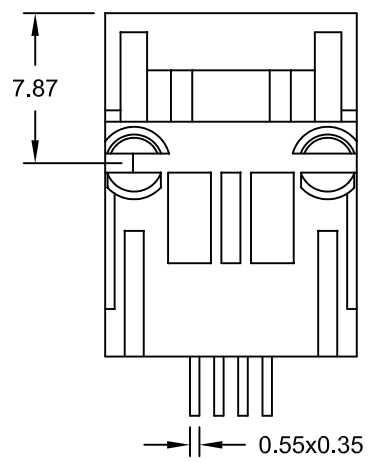
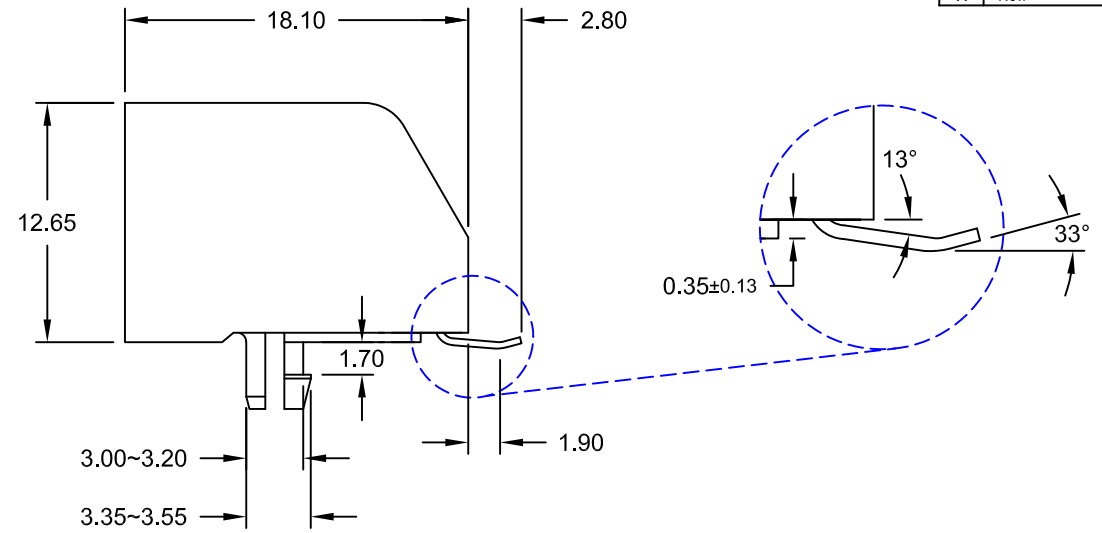
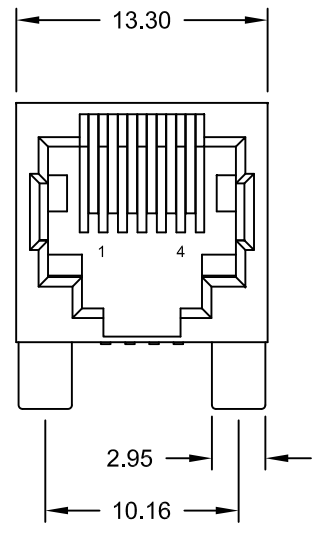

Specifications

Electrical
 Current rating: 1.5A max. (@25°C)
 Insulation resistance: 500MΩ min.
 Contact resistance: 15mΩ max.
 Voltage rating: 150V AC max.
 Withstanding voltage: 1000V rms / Minute (60Hz)

Material
 Contact: Phosphor Bronze
 Plating: Au over Ni
 Insulator: PA46 (black) UL 94V-0

Operating temperature: -40°C to +85°C
 Processing temperature: +250°C +0/-5°C for 10 secondss

Cavity comply with FCC Rules and Regulations Part 68, Subpart F

Recommended PCB Layout Top View
(Tolerance ±0.05)

PART NUMBER	GOLD PLATING CONTACT AREA
MJS-164-TRD3M0-56	6μ"
MJS-164-TRD3M0-57	15μ"
MJS-164-TRD3M0-58	30μ"
MJS-164-TRD3M0-5H	50μ"

E-tec 2016 © - all rights reserved



UNIT mm	GENERAL TOLERANCE		DRAWN Ryan	DATE 04.03.2016	DWG. NO. 1711403	SHEET 1/1				
	SCALE Free	X.° ±					X. ±	CHECK Ronny	DATE 08.03.2016	SERIES NO. MJS-164-TRD3M0-xx
		.XX° ±					.XX ± 0.25			
		.XXX° ±					.XXX ±			
			APPROVE Hogi	DATE 08.03.2016		REV. A				

SMT PCB Jack RJ14 <6P4C>
 Side Entry open body "Tab down"
 medium profile NON shielded