

REV.	LOCAS.	DESCRIPTION	DATE	DRAWN
A		NEW	17.02.1994	KATHY
B		PN: -T153-9x/2D -> -T1S0-9x	16.02.2009	RONNY
C		New DWG. No.	01.02.2012	RONNY

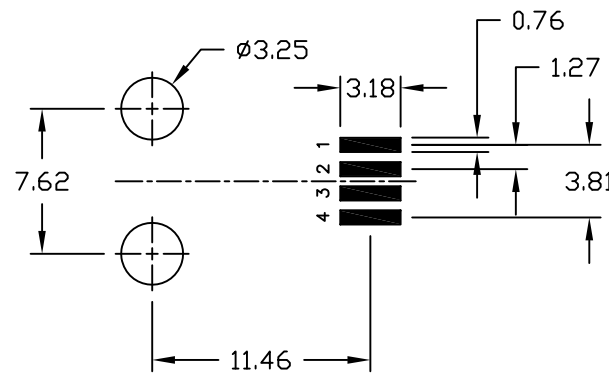

PCB LAYOUT TOP VIEW

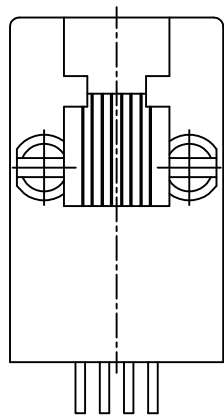
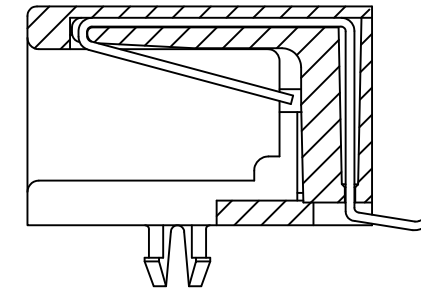
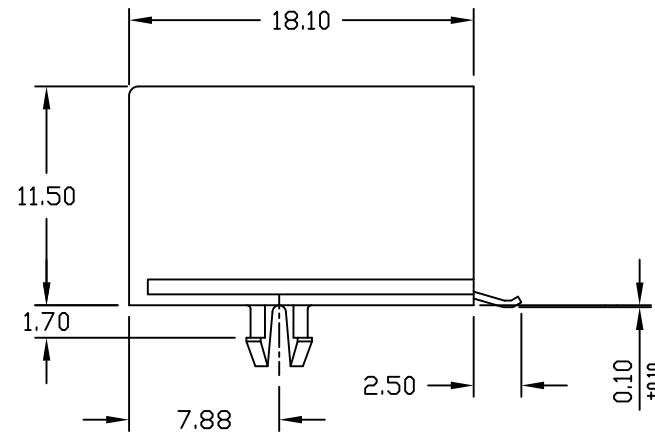
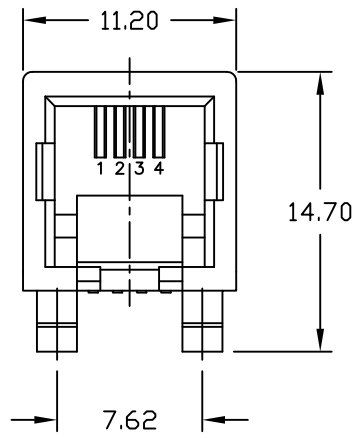

**NOTE**

- Material:  
Housing: Nylon UL 94V-0  
Contact: Phosphor Bronze  
Contact plating: Sn over Ni on solder area  
Au over Ni on contact area
- Electrical:  
Current rating: 1.5A max. @ 25°C  
Voltage rating: 150V AC max.  
Contact resistance: 15mΩ max.  
Dielectric withstanding Voltage:  
1000V rms 1 Minute 60Hz  
Insulation resistance: 500MΩ min.
- Environmental:  
Operating temperature: -20°C to +85°C  
Processing temperature: 250°C ±0/-5°C  
for 10 seconds

PART NUMBER	GOLD PLATING CONTACT AREA
MJS-144-T1S0-96	6μ"
MJS-144-T1S0-97	15μ"
MJS-144-T1S0-98	30μ"
MJS-144-T1S0-9H	50μ"

UNIT	GENERAL TOLERANCE		DRAWN	DATE	DWG. NO.	SHEET 1/1
mm	X.° ± 5°	X. ± 0.30	Kathy	17.02.1994	1711100	REV. C
SCALE	.X° ± 3°	.X ± 0.25	Ronny	01.02.2012		
Free	.XX° ± 2°	.XX ± 0.15	HOGI	01.02.2012	SERIES NO.	
	.XXX° ± 1°	.XXX ± 0.10			MJS-1xx-T1S0-9x	

**SMT PCB JACK SIDE ENTRY**  
**RJ9 <4P4C>**  
**UNSHIELDED**



REV.	DESCRIPTION	DATE	DRAWN
A	New	11.03.2016	Cherry

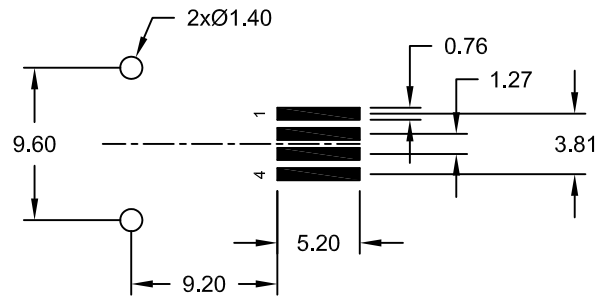
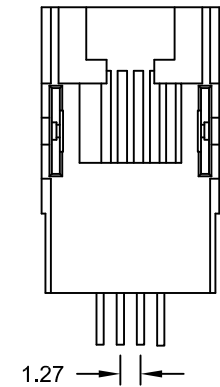
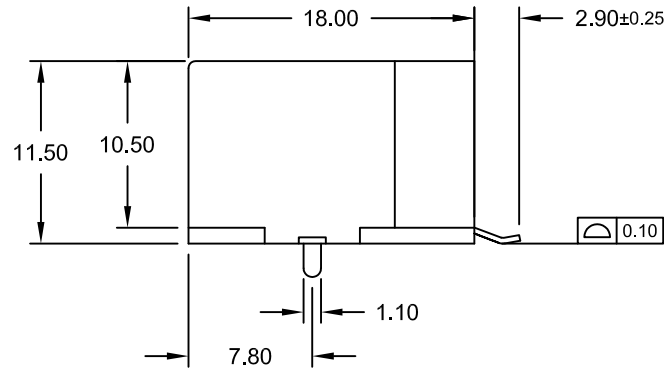
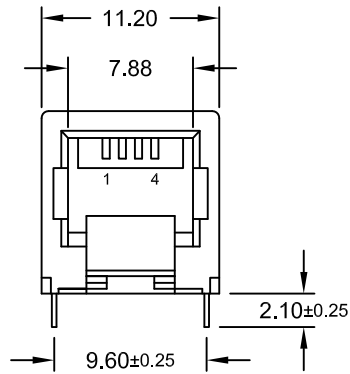

Recommended PCB Layout Top View  
(Tolerance ±0.05)



### Specifications

#### Electrical

Current rating: 1.5A max.  
 Insulation resistance: 500MΩ min.  
 Voltage rating: 150V AC max.  
 Withstanding voltage: 1000V rms / Minute (60Hz)  
 Contact resistance: 15mΩ max.

#### Material

Contact: Phosphor Bronze t=0.35mm  
 Plating: Au flash on solder area;  
 Au on contact area (see PN code)  
 Straight solder tab: Copper Alloy t=0.30mm  
 Plating: Sn  
 Insulator: PA9T (black) UL 94V-0

Operating temperature: -40°C to +85°C  
 Processing temperature: +250°C +0/-5°C  
 for 10 seconds

Cavity comply with FCC Rules and Regulations Part 68,  
 Subpart F

#### Packing

Tray

PART NUMBER	GOLD PLATING CONTACT AREA
MJS-144-PD3S0-56	6μ"
MJS-144-PD3S0-57	15μ"
MJS-144-PD3S0-58	30μ"
MJS-144-PD3S0-5H	50μ"

E-tec 2016 © - all rights reserved



UNIT	mm	GENERAL TOLERANCE		DRAWN	Cherry	DATE	11.03.2016	DWG. NO.	1711102	SHEET 1/1
	SCALE	Free	X.° ±		X. ±		CHECK		Ronny	
			.XX° ±	.XX ± 0.13	APPROVE	Hogi	DATE	14.03.2016	SERIES NO.	MJS-144-PD3S0-xx
			.XXX° ±	.XXX ±						

**SMT PCB Jack Side Entry**  
**RJ9 <4P4C> "Tab down"**  
 non shielded  
 with straight solder tabs

REV.	DESCRIPTION	DATE	DRAWN
A	New	11.03.2016	Cherry

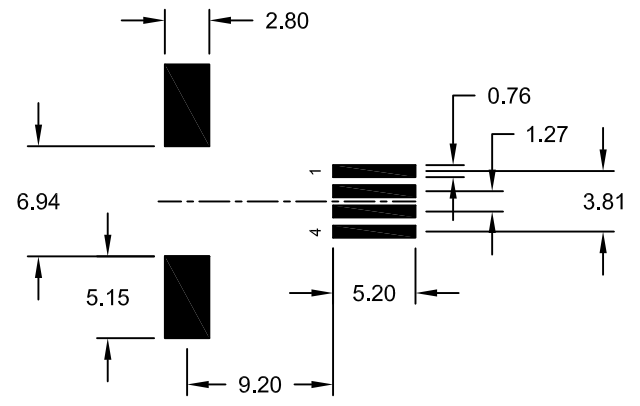
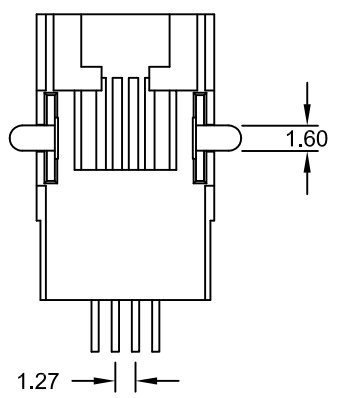
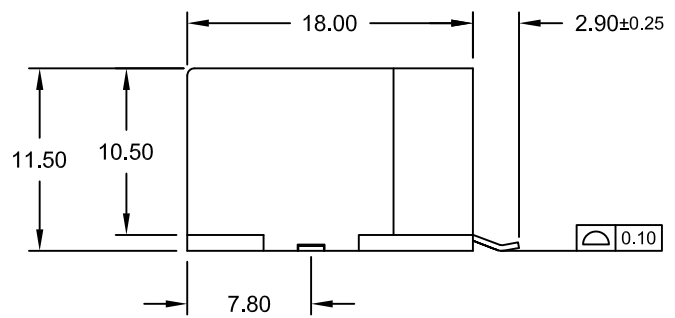
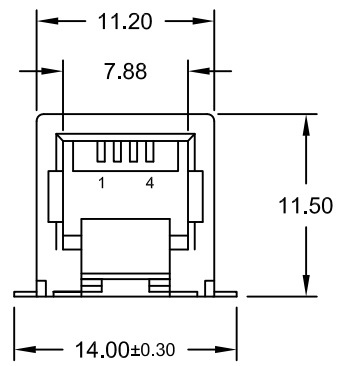

**Specifications**

**Electrical**

Current rating: 1.5A max.  
 Insulation resistance: 500MΩ min.  
 Voltage rating: 150V AC max.  
 Withstanding voltage: 1000V rms / Minute (60Hz)  
 Contact resistance: 15mΩ max.

**Material**

Contact: Phosphor Bronze t=0.35mm  
 Plating: Au flash on solder area;  
 Au on contact area (see PN code)  
 Wing solder tab: Copper Alloy t=0.30mm  
 Plating: Sn  
 Insulator: PA9T (black) UL 94V-0

Operating temperature: -40°C to +85°C  
 Processing temperature: +250°C +0/-5°C  
 for 10 secondss

Cavity comply with FCC Rules and Regulations Part 68,  
 Subpart F

**Packing**

Tray (Standard); Reel (Option)

Packing option  
 /R = Reel  
 no suffix = Tray (Standard)

PART NUMBER	GOLD PLATING CONTACT AREA
MJS-144-WD3S0-56/R	6μ"
MJS-144-WD3S0-57/R	15μ"
MJS-144-WD3S0-58/R	30μ"
MJS-144-WD3S0-5H/R	50μ"

Recommended PCB Layout Top View  
 (Tolerance ±0.05)

E-tec 2016 © - all rights reserved



UNIT mm	GENERAL TOLERANCE		DRAWN Cherry	DATE 11.03.2016	DWG. NO. 1711103	SHEET 1/1			
	SCALE Free	X.° ±					X. ±	CHECK Ronny	DATE 14.03.2016
		.XX° ±					.XX ± 0.13		
		.XXX° ±					.XXX ±		
		SERIES NO. MJS-144-WD3S0-xx/X							

**SMT PCB Jack Side Entry**  
**RJ9 <4P4C> "Tab down"**  
 non shielded  
 with wing solder tabs